

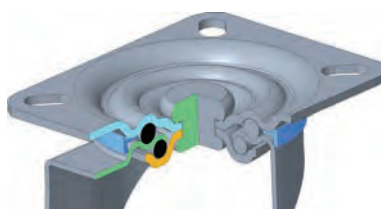

Tel: 04/257 68 20

Gsm: 040/99 00 11

Componenti in acciaio stampato zincati galvanicamente.
Rotazione piastra su doppia corona di sfere in acciaio temperato.
Piste rotazione sfere calibrate e lubrificate.
Anello di protezione sfere antipolvere.
Perno ribadito per assemblaggio supporto.
Frenature integrali a pedale regolabile.



Pressed steel, zinc-plated components.
Double ball races with hardened steel balls.
Calibrated and lubricated ball race tracks.
Dust protection ring.
Riveted or bolted central pin for assembling.
Adjustable brake foot lever.

girevole piastra / swivel castor



80x25	105x85	80x60	9x16	38	108		1PGA0800GR0	50	1PMB0800GR0	1PMB0800GX0
100x30	105x85	80x60	9x16	38	128		1PGA1000GR0	70	1PMB1000GR0	1PMB1000GX0
125x37,5	105x85	80x60	9x16	45	155		1PGA1250GR0	100	1PMB1250GR0	1PMB1250GX0
160x40	135x110	105x80	11x16	55	199		1PGA1600GR0	135	1PMB1600GR0	1PMB1600GX0
180x50	135x110	105x80	11x16	55	219		1PGA1800GR0	170	1PMB1800GR0	1PMB1800GX0
200x50	135x110	105x80	11x16	55	239		1PGA2000GR0	205	1PMB2000GR0	1PMB2000GX0
150x35	105x85	80x60	9x16	45	183		1PGA150GR0	125	1PMB150GR0	1PMB150GX0

girevole piastra freno pedale anteriore regolabile / swivel castor with adjustable front brake foot lever



80x25	105x85	80x60	9x16	38	108	120	1PGA0800GRI	50	1PMB0800GRI	1PMB0800GXI
100x30	105x85	80x60	9x16	38	128	120	1PGA1000GRI	70	1PMB1000GRI	1PMB1000GXI
125x37,5	105x85	80x60	9x16	45	155	120	1PGA1250GRI	100	1PMB1250GRI	1PMB1250GXI
160x40	135x110	105x80	11x16	55	199	140	1PGA1600GRI	135	1PMB1600GRI	1PMB1600GXI
180x50	135x110	105x80	11x16	55	219	140	1PGA1800GRI	170	1PMB1800GRI	1PMB1800GXI
200x50	135x110	105x80	11x16	55	239	140	1PGA2000GRI	205	1PMB2000GRI	1PMB2000GXI
150x35	105x85	80x60	9x16	45	183	120	1PGA150GRI	125	1PMB150GRI	1PMB150GXI

girevole foro per vite / bolt hole swivel castor



80x25	12	77		38	104		1PGA0800QR0	50	1PMB0800QR0	1PMB0800QX0
100x30	12	77		38	124		1PGA1000QR0	70	1PMB1000QR0	1PMB1000QX0
125x37,5	12	77		45	151		1PGA1250QR0	100	1PMB1250QR0	1PMB1250QX0
160x40	16	103		55	193		1PGA1600QR0	135	1PMB1600QR0	1PMB1600QX0
180x50	16	103		55	213		1PGA1800QR0	170	1PMB1800QR0	1PMB1800QX0
200x50	16	103		55	233		1PGA2000QR0	205	1PMB2000QR0	1PMB2000QX0
150x35	12	77		45	179		1PGA150QR0	125	1PMB150QR0	1PMB150QX0

girevole foro per vite freno pedale anteriore regolabile / bolt hole swivel castor with adjustable front brake foot lever



80x25	12	77		38	104	120	1PGA0800QRI	50	1PMB0800QRI	1PMB0800QXI
100x30	12	77		38	124	120	1PGA1000QRI	70	1PMB1000QRI	1PMB1000QXI
125x37,5	12	77		45	151	120	1PGA1250QRI	100	1PMB1250QRI	1PMB1250QXI
160x40	16	103		55	193	140	1PGA1600QRI	135	1PMB1600QRI	1PMB1600QXI
180x50	16	103		55	213	140	1PGA1800QRI	170	1PMB1800QRI	1PMB1800QXI
200x50	16	103		55	233	140	1PGA2000QRI	205	1PMB2000QRI	1PMB2000QXI
150x35	12	77		45	179		1PGA150QRI	125	1PMB150QRI	1PMB150QXI

Varianti/Options



Montaža

Slika je simbolična



Vilice po naročilu tudi v INOX izvedbi!



fisso piastra / fixed castor



Varianti/Options

80x25	105x85	80x60	9x16	108	1PGA0800FIO	50	1PMB0800FIO	1PMB0800FX0	
100x30	105x85	80x60	9x16	128	1PGA1000FIO	70	1PMB1000FIO	1PMB1000FX0	
125x37,5	105x85	80x60	9x16	155	1PGA1250FIO	100	1PMB1250FIO	1PMB1250FX0	
160x40	135x110	105x80	11x16	199	1PGA1600FIO	135	1PMB1600FIO	1PMB1600FX0	
180x50	135x110	105x80	11x16	219	1PGA1800FIO	170	1PMB1800FIO	1PMB1800FX0	
200x50	135x110	105x80	11x16	239	1PGA2000FIO	205	1PMB2000FIO	1PMB2000FX0	





Tel: 04/257 68 20
Gsm: 040/99 00 11

RUOTE NUCLEO TERMOPLASTICO ANELLO GOMMA NERA STANDARD PLASTIC CENTRE WHEELS WITH BLACK STANDARD RUBBER TYRE

Caratteristiche Ruota

Anello in gomma nera qualità standard.
Struttura portante in materiale plastico antiurto colore nero.
Movimento mozzo:
alesaggio passante
gabbia a rulli
Temperatura d'impiego da -10°C a +60°C.
Discreta resistenza agli aggressivi chimici.
Durezza battistrada 83 Sh.A +/- 4
Discreta resistenza all'abrasione.
Velocità massima di lavoro 4 km/h.
Mezzo di trazione consigliato: manuale

Wheel Features

Black standard rubber tyre.
Shock resistant black plastic centre wheel.
Type of bearing:
plain bearing
roller bearing.
Temperature range: from -10°C to +60°C.
Fair resistance to chemicals.
Tread hardness 83 Sh.A +/- 4.
Fair resistance to abrasion.
Max. working speed 4 KPH.
Operation: manual.



1

Pavimentazioni Idonee / Floring Type



80x25	OPGA080012	12x40	50
100x30	OPGA100012	12x40	70
125x37,5	OPGA125015	15x46	100
160x40	OPGA160020	20x60	135
180x50	OPGA180020	20x60	170
200x50	OPGA200020	20x60	205

Anello in gomma grigia qualità standard.
Struttura portante in materiale plastico antiurto colore grigia.
Movimento mozzo:
alesaggio passante
gabbia a rulli
Temperatura d'impiego da -10°C a +60°C.
Discreta resistenza agli aggressivi chimici.
Durezza battistrada 83 Sh.A +/- 4
Discreta resistenza all'abrasione.
Velocità massima di lavoro 4 km/h.
Mezzo di trazione consigliato: manuale

Grey standard rubber tyre.
Grey elastic rubber tyre.
Shock resistant grey plastic centre wheel.
Type of bearing:
self-lubricating polyamide bush.
roller bearing
roller bearing with steel tube.
Temperature range: from -10°C to +60°C.
Fair resistance to chemicals.
Tread hardness 83 Sh.A +/- 4.
Fair resistance to abrasion.
Max. working speed 4 km/h.
Operation: manual.



80x25	OPMB080012	12x40	50
100x30	OPMB100012	12x40	70
125x37,5	OPMB125015	15x46	100
160x40	OPMB160020	20x60	135
180x50	OPMB180020	20x60	170
200x50	OPMB200020	20x60	205

Varianti / Options

Le dimensioni riportate sulle pagine del nostro catalogo sono espresse in millimetri
All dimensional sizes shown on our catalogue are in millimeters.